

**NOTE:**  
**GENERAL CONSTRUCTION TOLERANCE:  $\pm 5$  mm [ $\pm 0.2$ "]**  
**INSTALLATION REQUIREMENT**  
**SPACE FOR MAINTENANCE ABOVE TOP OF THE CABIN ON THE INTERNAL SIDE:**  
 \*MIN. 300 mm [11.81"]  
 \*RECOMMENDED 750 mm [29.53"]  
 \*if space does not meet the required specifications contact us to discuss alternatives

**FRONT VIEW**  
 NON SECURE SIDE

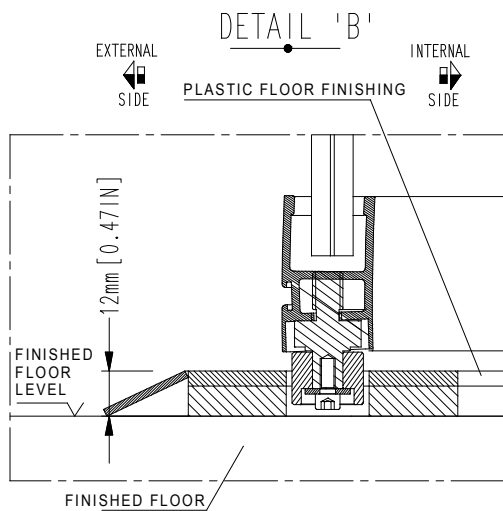
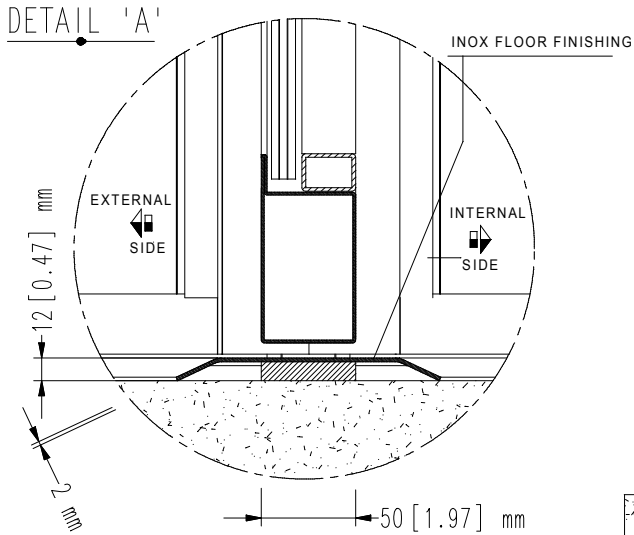
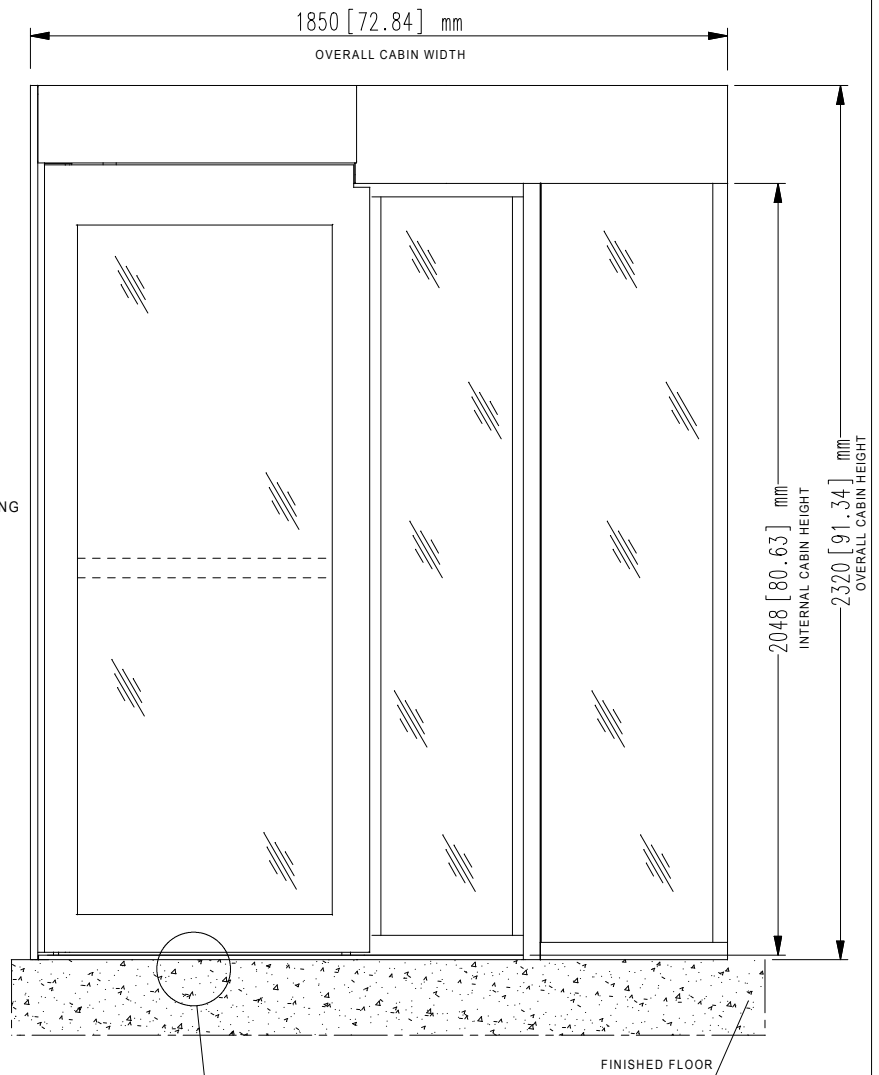

**NOTE:**  
 - unit must be installed on to a level floor (suggested flatness tolerance:  $\pm 1$  mm)  
 - coating option: 2 mm thickness in addition to size

**TOP VIEW**

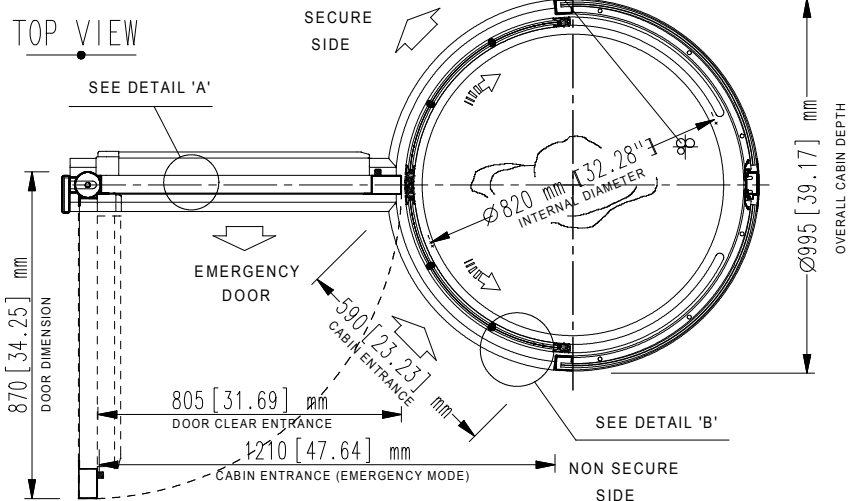

3	09/01/2018	MODIFIED DIMENSIONS	ISABELLA
2	30/06/2017	UPDATED FONT	ISABELLA
REV	DATE	REVISION DESCRIPTION	DRAWN BY
DRAWN BY: ISABELLA		DESIGNED AND MANUFACTURED BY: <b>aalluser</b> INDUSTRIE designed for your security	DISTRIBUTED BY:
DATE: 26/04/2017			
DRAWING NUMBER: EARC379			
REVISION: 3		TITLE/DESCRIPTION <b>C5R-C5KR MY16 REVERSIBLE</b>	<i>Flush mounted to floor (no recess required)</i> <i>Overall dimensions and mechanical installation requirement</i>
SCALE: 1:20			
PAGE 1 OF 1			

THIS DOCUMENT IS AN ALLUSER INDUSTRIE PROPERTY AND IT CANNOT BE COPIED OR TRANSFERRED TO THIRD PARTIES WITHOUT A PREVIOUS WRITTEN AUTHORIZATION. DUE TO OUR POLICY OF CONTINUOUS PRODUCT DEVELOPMENT, ALL DIMENSIONS AND SPECIFICATIONS DESCRIBED IN THIS DOCUMENT ARE SUBJECT TO CHANGE WITHOUT NOTICE.